

APPLIED RESEARCH BUILDING

DATE: **8/16/21 - 8/20/21**

PHASE: **Overall Project View**



Jobsite camera
facing south

The north shear-walls of the building are up and ready for concrete. Shear walls provide major structural support for the building concrete cast in place structure

Jobsite camera
facing north



APPLIED RESEARCH BUILDING

DATE: **8/16/21 - 8/20/21**

PHASE: **Tower Crane & Caissons**

Tower Crane
base completed
& protected

This crane will have the
capacity to pick up
to 15,400lb at 197' and up
to 26,400lb within 115'.



Final caisson
drilling in
progress -
Caissons
support the
mass
foundation
systems

APPLIED RESEARCH BUILDING

DATE: **8/16/21 - 8/20/21**

PHASE: **Foundations**



These deep foundations are over 8 feet in depth. The deep foundations will secure the load of the structure & keep it supported to prevent a major deflection and/or any sliding in the soil.

Deep excavation completed for elevator 2 and stair 2.



East grade
beam reinforcing

APPLIED RESEARCH BUILDING

DATE: **8/16/21 - 8/20/21**

PHASE: **Vertical Structure**



The north shear-walls of the building are up and ready for concrete. These walls will support the building structure and hold the roll up door in-between them.

Shear-walls
and columns -
Main building
structure



Level 1 - Steel embeds
onsite

APPLIED RESEARCH BUILDING

DATE: 8/16/21 - 8/20/21

PHASE: Mechanical/Electrical/Plumbing



The north vault will be the pathway to provide permanent building power

North Vault Placement

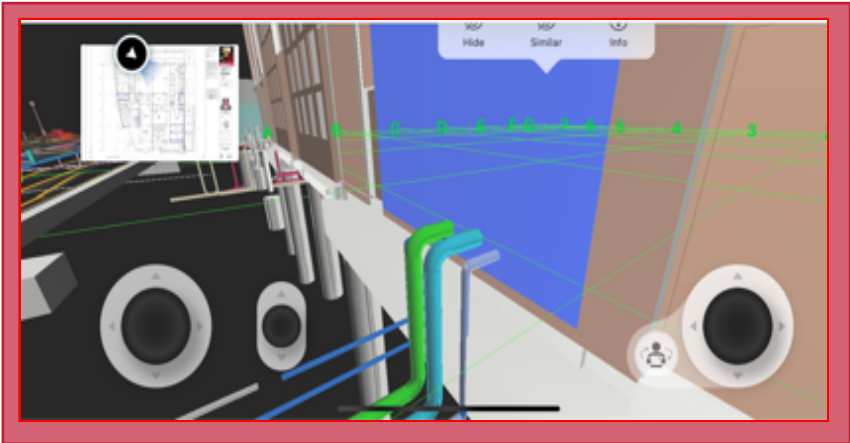

Level 1 Building Information Modeling is finalized.



APPLIED RESEARCH BUILDING

DATE: **8/16/21 - 8/20/21**

PHASE: **What's Next?!**

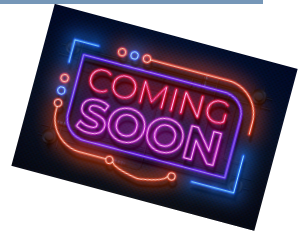

- **Electrical Infrastructure Outage and Tie-In completion to provide permanent power.**
- **Temp Vista Switchgear, which is an electrical distribution gear providing main building power.**
- **Embeds and Underground MEP rough-in.**
- **Vertical Structure concrete pours.**
- **Grade Beams and Foundations complete reinforcing, inspection and pour concrete.**
- **Demo and remove old encasement pads.**



McCarthy + SmithGroup
ARB Design Build Team