



# APPLIED RESEARCH BUILDING

DATE: 08/22/22 - 09/05/22

PHASE: Project Overview



Facing North View



Facing South View



McCarthy + SmithGroup  
ARB Design Build Team

# APPLIED RESEARCH BUILDING

DATE: 08/22/22 - 09/05/22

PHASE: Water Retention Tanks



Installing the Tanks on NW Corner



Tanks Backfilled and Protected

### Fun Fact:

This underground storm water retention system is designed to allow the Highland Corridor bike path to be built over the top of it.

These tanks will capture and temporarily store up to 187,000 gallons of storm water runoff!

This helps mitigate water and sediment from overflowing onto walkways or roads.

Over time, the water will naturally dissipate through the soil below.

# APPLIED RESEARCH BUILDING

DATE: **08/22/22 - 09/05/22**

PHASE: **South Elevation Landscape**



Site Excavations for Storm Water pipe that will connect into the underground storage tank system



More storm water pipes are being installed at the South/Southeast sides of the building

# APPLIED RESEARCH BUILDING

DATE: 08/22/22 - 09/05/22

PHASE: **Flooring**



Raised Access Flooring



### Fun Fact:

The raised access floor gives access to the electrical and data pathways underneath, and allows for a flexible space that can fulfill different furniture layouts for different needs.

# APPLIED RESEARCH BUILDING

DATE: 08/22/22 - 09/05/22

PHASE: Glass Installation

The storefront will allow pedestrians and bicyclists passing by to see the Thermal Vacuum Chamber.

The colored striped pattern embedded inside the glass provides a unique, shimmering/shading effect.

This sophisticated window system will decrease the air conditioning loads required to cool the building.



First Piece of Glass Installed  
on the Applied Research  
Building!



# APPLIED RESEARCH BUILDING

DATE: 08/22/22 - 09/05/22

PHASE: Metal Panel Facade



East side: insulation and preparation for metal panels



Metal panel systems progress on the West and North sides.

Starting next week, the crew will be installing metal panels on the East side and working their way toward the South side.



McCarthy + SmithGroup  
ARB Design Build Team



# APPLIED RESEARCH BUILDING

DATE: 08/22/22 - 09/05/22

PHASE: **What's next?!?**



- North Yard Walls and Gates
- Exterior Glass installation
- Specialty Bi-fold Doors
- Clean Room Walls Panels

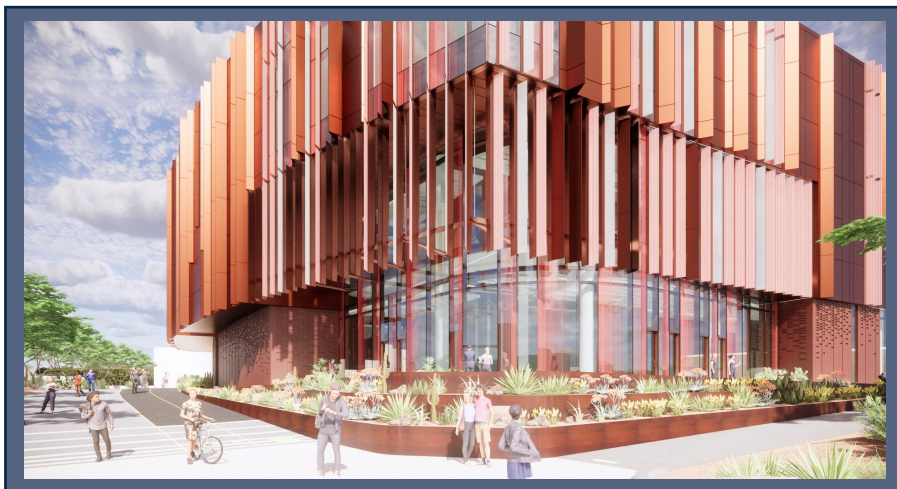

McCarthy + SmithGroup  
ARB Design Build Team